

THIS COPY IS PROVIDED ON A RESTRICTED BASIS AND IS NOT TO BE USED IN ANY WAY DETRIMENTAL TO THE INTERESTS OF PANDUIT CORP.

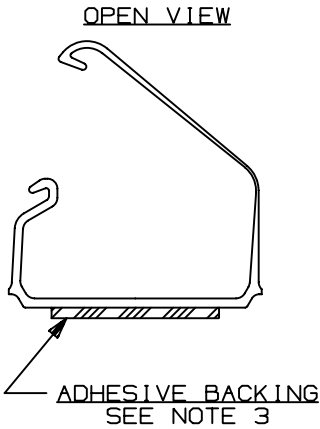

△K

△M

| PART NAME | PANDUIT PART NUMBER (SEE NOTE 1) | LENGTH in. (mm.) | STATIC LOAD (SEE NOTE 2) | APPROX. WEIGHT |
|---------------|----------------------------------|-------------------------|--------------------------|-------------------------|
| LATCHING DUCT | LD10**6-A | 72.0±.09 (1829±2.3) | .61 lbs/in (10.9 g/mm) | .122 lbs/ft (.182 g/mm) |
| | LD10**8-A | 96.0±.09 (2438±2.3) | .61 lbs/in (10.9 g/mm) | .122 lbs/ft (.182 g/mm) |
| | LD10**10-A | 120.0±.09 (3048±2.3) | .61 lbs/in (10.9 g/mm) | .122 lbs/ft (.182 g/mm) |
| | LD10**2-A | 78.74±.09 (2000.0±2.3) | .61 lbs/in (10.9 g/mm) | .122 lbs/ft (.182 g/mm) |
| | LD10**3-A | 118.11±.09 (3000.0±2.3) | .61 lbs/in (10.9 g/mm) | .122 lbs/ft (.182 g/mm) |

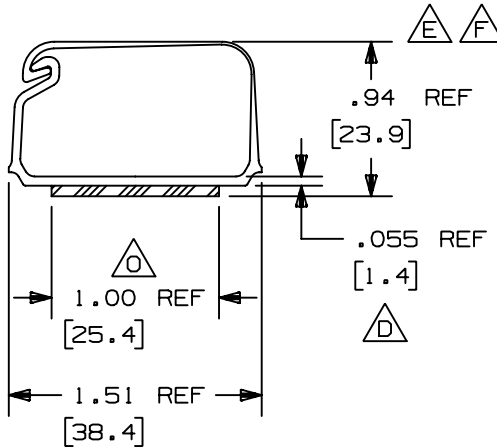

NOTES:

1. SEE CURRENT CATALOG FOR ADDITIONAL PART NUMBER SUFFIXES TO INDICATE COLOR AND OR PACKAGED QUANTITY.
2. PART IS DESIGNED TO SUPPORT MAXIMUM WEIGHT ON A CLEAN, DRY, SMOOTH SURFACE. THE SURFACE MUST BE PROPERLY PREPARED IN ACCORDANCE WITH PANDUIT RECOMMENDATIONS.
3. PRESSURE SENSITIVE FOAM .040 (1.0) THICK WITH PROTECTIVE LINER.
4. TO APPLY PART:
 - a. REMOVE PROTECTIVE LINER.
 - b. PLACE PART IN DESIRED LOCATION.
 - c. APPLY PRESSURE TO FLAT SURFACE OF PART.
5. DIMENSIONS IN PARENTHESES ARE METRIC.
6. NO WARRANTY, EXPRESSED OR IMPLIED, IS MADE BY PANDUIT WITH RESPECT TO ADHESIVE BOND PERFORMANCE, AMONG OTHER THINGS, THE CONDITIONS UNDER WHICH THESE MOUNTS MAY BE APPLIED AND/OR THE SURFACE TO WHICH THEY MAY BE APPLIED ARE BEYOND PANDUIT'S CONTROL.

△

CAD FILENAME/LAYERS D17832BA_DC_LD10_02A.PRT

| | | | | | | | | | |
|-----|----------|------|------|--|-------|------|------|-----|--|
| 11 | 06-12-03 | JHEP | RMHI | O. REVISED TAPE WIDTH; 1.00 WAS 1.25 | 17832 | RGRO | RGRO | | |
| 10 | 11-19-98 | DW | HIW | N. REVISED NOTE 2 M. ADDED LD10**2-A AND LD10**3-A TO CHART | 17832 | HIW | HIW | | |
| 9 | 02-13-98 | PM | HIW | L. FILE NAME WAS WPXD-LATCHING-DUCT_02.PRT K. REVISED CHART AND NOTES | 17832 | HIW | HIW | | |
| - | ----- | --- | --- | J. ADDED PARTS LD10**8-A AND LD10**10-A | ----- | --- | --- | | |
| 8 | 07-30-97 | RACB | HIW | I. REVISED NOTES H. REVISED REVISION SYMBOLS | 17832 | HIW | HIW | | |
| - | ----- | --- | --- | G. DELETED NON-STANDARD NOTE 4 | ----- | --- | --- | | |
| - | ----- | --- | --- | F. OMIT LATCHING CLIP LC10-A FROM DWG REFER TO 34348-2 FOR LATCH CLIP DWG | ----- | --- | --- | | |
| 7 | 06-10-92 | DW | CEF | E. REVISED NOTE 1 AND OMIT COLOR FROM DWG D. ADDED THICKNESS DIMENSION .055 | 17832 | 7 | | | |
| REV | DATE | BY | CHK | DESCRIPTION | ECN | R | CUST | SUP | |

| | | | |
|---|---|---|------------------|
| PANDUIT | | CORP. TINLEY PARK, ILLINOIS | |
| LATCHING DUCT (LD10) | | | |
| CUSTOMER DRAWING | | | |
| UNLESS OTHERWISE SPECIFIED, DIMENSIONAL TOLERANCES ARE: (.X) ± (.XXX) ± (.XX) ± ANGLES ± | | UNLESS OTHERWISE SPECIFIED, ALL DIMENSIONS ARE GIVEN IN INCHES, THIRD ANGLE PROJECTION. | |
| DRAWN BY GDN | MAT'L: RIGID PVC (POLYVINYL CHLORIDE) | SCALE FULL | |
| DATE 11-19-82 | | DRAWING NO. SS-17832 | DWG A SIZE |
| CHK'D HVP | | | |